



**OILMIN**



# **Capability Statement**

A Modular Building System

# Ezy House

OILMIN is the exclusive distributor and agent for the Ezy House Flat Packs in Papua New Guinea. Ezy House offers a cost effective, modular, flat pack solution for camps throughout Papua New Guinea. These units are plug & play installation and comply to International Standards. They are shipped in 20" ISO container sized bundles—certified for international shipping.

- ✓ Modular System
- ✓ 20' ISO Container size
- ✓ Certified for international shipping
- ✓ Easy trucking
- ✓ Easy handling at site
- ✓ Cost effective & fast
- ✓ Flat packed in 'Kit Form'
- ✓ Fast & Easy Installation
- ✓ International standards
- ✓ Plug & Play
- ✓ Customizable Layouts



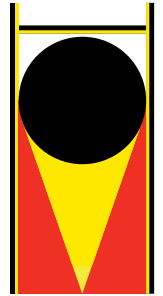

# Modular Building Blocks

- ✓ The units are built to the highest International Standard and designed as a multi function modular building system.
- ✓ The Units can be connected at the longitudinal and transverse directions without limits.They can be stacked 2 or 3 high, creating different floors.
- ✓ The wainscots of the units are made of light insulated panels and offer a pleasant climate in the interior due to their building and physical properties.
- ✓ The standard units are fitted with windows, external or internal doors, PVC rolling shutters and full electricity fittings according to various international standards and regulations, consisting of a distribution box, various power plugs, light switches and neon lights.
- ✓ Various Accessories available



## Assembly

- ✓ Flat-pack units are placed on concrete or equivalent foundations.
- ✓ Individual modules can be lifted by crane and pushed into position
- ✓ Modules are coupled together by special brackets and then “daisy chained” to run the electricity
- ✓ Walls can be removed or inserted depending on the design of the layout
- ✓ Modules are certified for stacking
- ✓ Secondary roof sections are installed for additional rain protection and in areas with tropical downpours.



# Basic Units

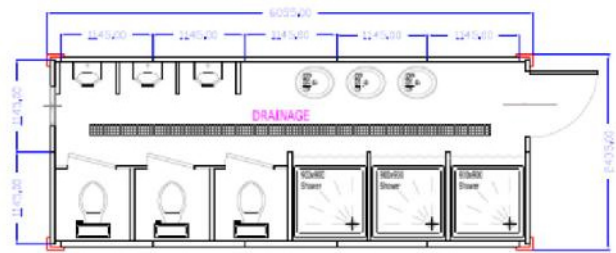
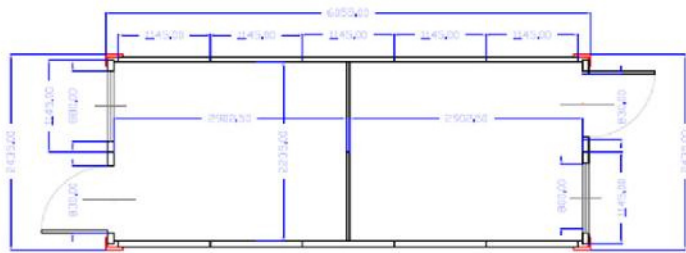
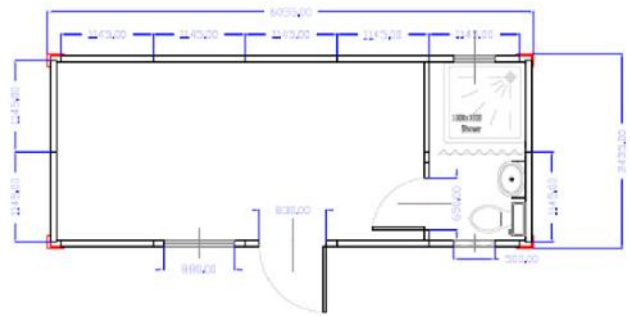
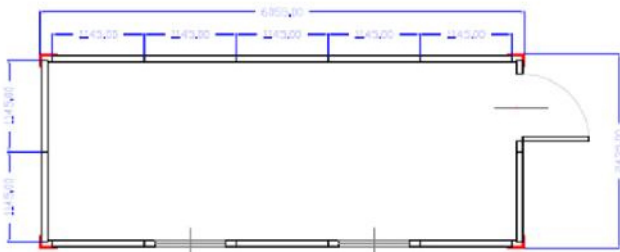

# Camp Projects



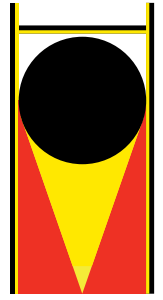

# 1-Man Sleeper (EH 114)

## Dimensions

6.05m (l) x 2.44m (w) x 2.79 (h), 14.75 sqm

- ✓ 1 x King-single bed, spring mattress
- ✓ 1 x desk with office chair
- ✓ 1 x 2-door wardrobe
- ✓ 1 x A/C unit (12,000 BTU)
- ✓ Sliding toilet door
- ✓ 1 x shower unit, hot & cold taps
- ✓ 1 x 55ltr hot water boiler
- ✓ 1 x hand wash basin, hot & cold taps
- ✓ 1 x toilet c/w toilet roll dispenser
- ✓ 1 x vanity mirror with small shelf
- ✓ 1 x towel rack
- ✓ 1 x single socket for wet area
- ✓ 1 x exhaust fan or small toilet window



# 2-Men Sleeper (EH 104)

## Dimensions

6.05m (l) x 2.44m (w) x 2.79 (h), 14.75 sqm

- ✓ 2 x standard beds, spring mattress
- ✓ 2 x desk with office chair
- ✓ 2 x single door locker
- ✓ 2 x A/C units (12,000 BTU each)
- ✓ Common bathroom facilities in the block



## 4-Men Sleeper (EH 101)

### Dimensions

6.05m (l) x 2.44m (w) x 2.79 (h), 14.75 sqm

- ✓ 2 x bunk beds c/w drawer, spring mattress
- ✓ 1 x desk with chair
- ✓ 4 x single door lockers
- ✓ 1 x A/C unit (12,000 BTU)
- ✓ Common bathroom facilities in the block

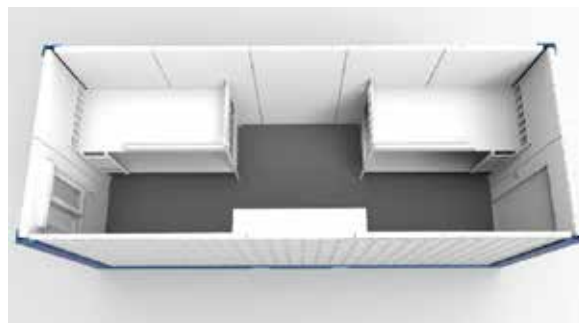

## Ablution Unit (AB102)

### Dimensions

6.055m (l) x 2.435 (w) x 2.79 (h)

- ✓ 3 x shower unit, hot & cold taps
- ✓ 2 x hand wash basin, hot & cold taps
- ✓ 3 x toilets c/w toilet roll dispenser
- ✓ 2 x Urinals c/w privacy partition
- ✓ 2 x vanity mirror with small shelf
- ✓ 2 x single socket for wet area
- ✓ 1 x exhaust fan or small toilet window
- ✓ A/C and Hot Water Boiler on request

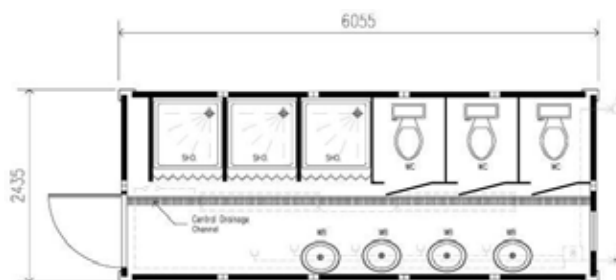









## Factory Shanghai



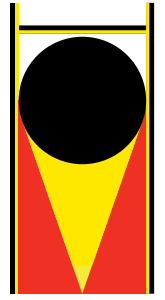

# Completed Projects



Construction Site Office



Workers Camp



Refugee Camp



Military Camp



Remote Drilling Camp



Pioneer Camp



VIP Accommodation Blocks



Accommodation Block



Project Reference where the Ezy-House™ has been used	Client	Project Size
UK Army Camp Bastion Afghanistan (2007)	UK Royal Marines	\$3,000,000
PNG LNG Quarry Office (2010)	Wagners International	\$210,000
Accommodation South Africa (2010)	Foster Wheeler (Johannesburg)	\$1,200,000
Site Office (2010)	Exxon Mobile	\$95,000
PNG LNG Site Office (2011)	BAM / Clough	\$500,000
Zambia Accommodation Camp (2011)	Equinox Lumwana	\$200,000
PNG Herd Base Accommodation 96 people (2011)	InterOil Pty Ltd	\$250,000
PNG Port Moresby Site Office (2011)	Chicago Bridge Iron (CBI)	\$325,000
PNG Herd Base Training Centre (2011)	InterOil Pty Ltd	\$220,000
PNG LNG Site Office (2011)	Agility	\$135,000
PNG Airport Office (2011)	Deurgo Pte Ltd	\$96,000
AUS Procurement Office Brisbane (2011)	Exxon Mobile	\$120,000
PNG Hou Creek Camp Facilities 150-man Accommodation / Kitchen / Medical (2012)	InterOil Pty Ltd	\$750,000
PNG 250 Men Camp Stanley Gas Project (2013)	Horizon / Talisman Energy	\$3,600,000
PNG Office Structure in 2 Phases (2015)	PNG Government – Department of Works	\$190,000
PNG Kerema Doctors, Nurses Accommodation (2014)	PNG Government – Department of Health	\$90,000
PNG Kerema Kitchen & Mess Room for 300 PAX (2014)	PNG Government – Department of Health	\$175,000



**OILMIN**

## OM HOLDINGS LTD

PO Box 8073 Boroko, 111 NCD,  
Papua New Guinea

### Physical Address

Lot 30, Sec 32 Ogoa Street  
Port Moresby  
Papua New Guinea

### Telephone

Port Moresby Office +675 3213153  
Mount Hagen Office +675 5421221

[www.oilmin.com](http://www.oilmin.com)